



Ruffle Close, Upper Floor Flat, West Drayton, UB7 9BP

- Two bedrooms
- Unfurnished
- Residential location
- EPC Rating- C
- First floor
- Access to train station
- Utility bills included
- Available for early February

£1,650 PCM

Description

A very well presented two double bedroom apartment located in a residential area close to the West Drayton train station. Split over two floors providing a reception room and kitchen to the first floor and two double bedrooms, family bathroom and en suite to the master to the second floor. Presented with neutral colours throughout and INCLUSIVE of utility bills. Tenant will be responsible for Council tax. Unfurnished and available for February.

Ground Floor
Approx. 22.4 sq. metres (241.2 sq. feet)

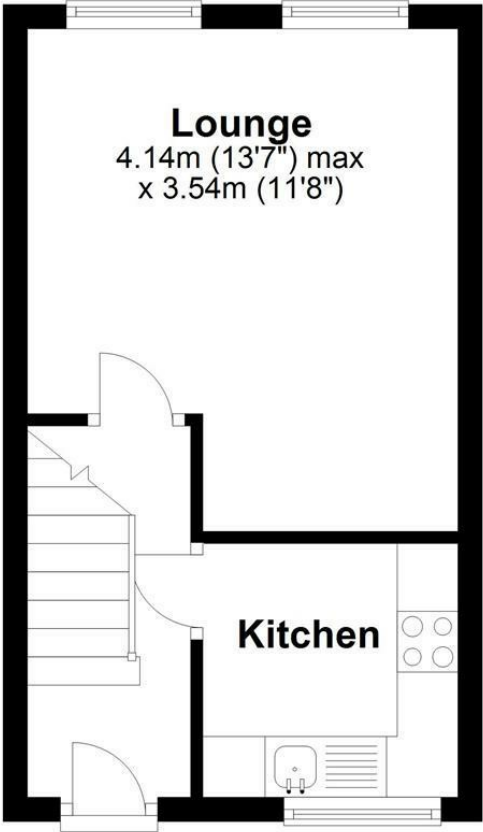

First Floor
Approx. 22.2 sq. metres (238.6 sq. feet)

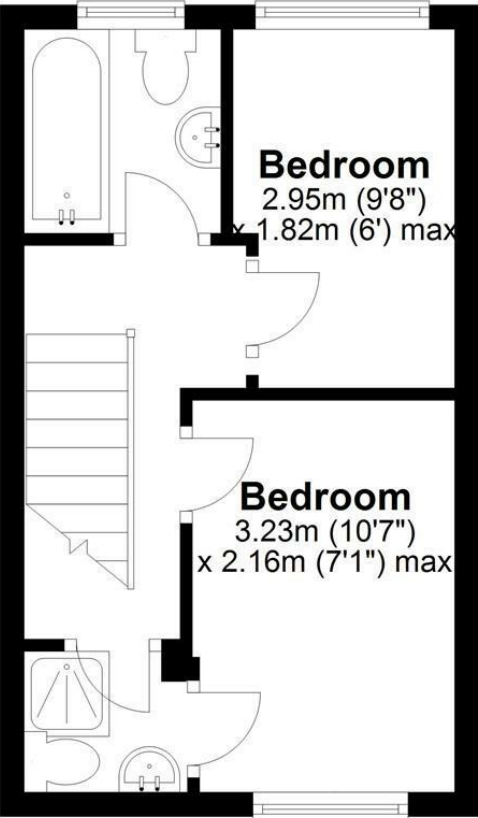

Total area: approx. 44.6 sq. metres (479.8 sq. feet)

IMPORTANT NOTICE

These particulars have been prepared upon information supplied by the Vendor and should be verified by your surveyors and solicitors. We have prepared these sales particulars as a general guide to give a broad description of the property. They are not intended to constitute part of an offer or contract. We have not carried out a structural survey and the services, appliances and specific fittings have not been tested. All photographs, measurements, floor plans and distances referred to are given as a guide only and should not be relied upon for the purchase of carpets or any other fixtures or fittings. Lease details service charge and ground rent (where applicable) are given as a guide only and should be checked and confirmed by your solicitor prior to exchange of contracts